

Bottled Water Installation

Required Materials and Tools

A five gallon bottle of water
Lavit Bottled Water Pump Kit
¼" NSF approved water tubing cutter

NOTE: It is the responsibility of the install to follow local codes



It is recommended that the power cord be connected to a GFCI outlet.

Installation Instructions

1. Locate the water pipe that is looped inside the side compartment.



YES



2. Cut the water pipe loop and place the two ends of the pipe into the Lavit Bottled Water Pump marked in and out. The right hand side of the loop is water in.

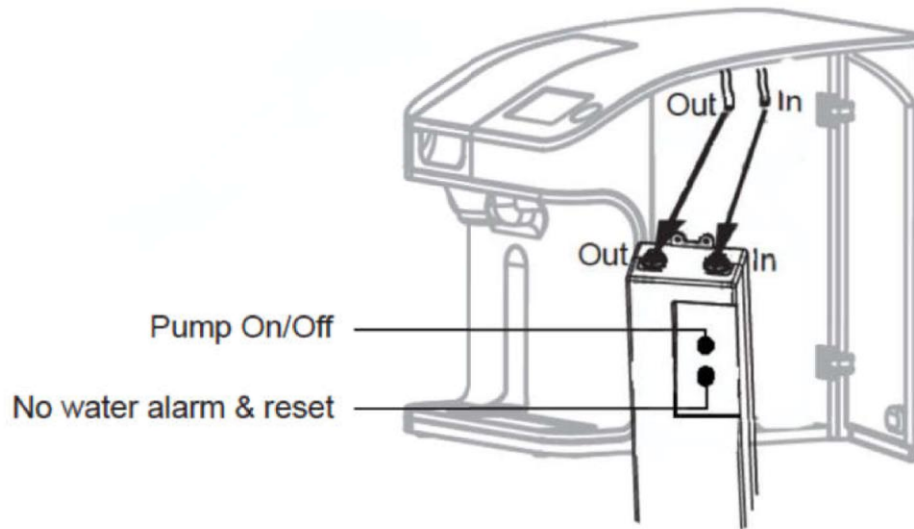

3. Fit the pump into the side compartment using the slots in the bottom of the panel and the screw attachment points. Plug the pump into the supplied power socket inside the compartment. Ensure the Pump Power Switch is OFF.
4. Place the 5 gallon bottle within six (6) feet of the machine and remove the bottle seal.
5. Fit the water bayonet into the bottle and seal the bottle with the cap located on the water bayonet.
6. Connect the $\frac{1}{4}$ " water tubing from the top of the water bayonet to the water inlet connection at rear of the dispenser.
7. Ensure that the Dispenser Power Switch is in the OFF position (bottom in). Connect the power cord.
8. Locate the CO₂ inlet pressure line inside the side compartment. Extend the line away from the dispenser and trim the line using a tubing cutter so that the final length of the tube extends to the inside of the door hinge.

12. The dispenser will self-check on every power up and if OK will go to the LCD home screen and the Lavit Button halo will be red.
13. **TO FILL THE DISPENSER WITH WATER, TURN THE LAVIT PUMP TO ON, PUSH THE LAVIT BUTTON AND THE DISPENSER WILL START TO FILL.** The screen will display a WATER TANK FILLING SCREEN.
14. When the water tanks are half filled, the compressor will turn on and start to chill. The soda pump will also turn on when the water tank is half full. The HOME screen will appear.
15. When the HOME screen appears turn the CO₂ gas pressure on. **SET THE REGULATOR TO 3.5 BAR OF PRESSURE BY ROTATING THE KNOB CLOCKWISE. 3.5 BAR OF PRESSURE (50 PSI) IS INDICATED AT THE BEGINNING OF THE RED SCALE ON THE REGULATOR.** The soda tank will fill with CO₂ gas.

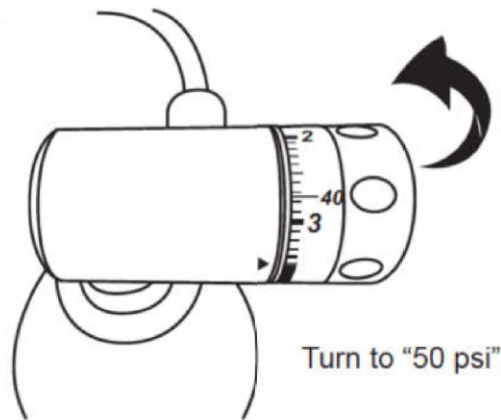

16. Purge any air from the system by toggling the CO₂ Purge Valve located in the rear of the unit. Purge gas about 3 times for 2 seconds each time.
17. If the water tanks do not fill within 5 minutes the water inlet valve will automatically close. This feature is a safety feature that prevents the continuous running of water in the case of a water leak. An error screen indicating a possible leak will be displayed. To clear the dispenser of this condition turn the power off and then back on. Reset the Lavit Pump if necessary (Red Light) by pushing the reset button on the pump. The reset should be green.
18. Push the Lavit Button again and the tanks will then automatically continue filling to capacity and shut off and the Lavit button halo will be blue.

19. While the water tanks are filling and the compressor is chilling the water, set the current date and time by pressing the gear shaped Service Icon on the lower left of the HOME screen.
20. From the Date/Time Screen, enter the Service Menu by pressing the Service Setup icon.
21. From the Service Menu select and make the following choices:
 - Enter MAX TEMP and DISABLE (when disabled the icon will read "Enable").
 - Set the Filter Timer to DISABLE (when Disabled the icon will read "Enable"). Filter life is not tracked for Bottled Water installations.
 - Enable or Disable Sleep Mode.

Select WATER SETUP and display the water calibration screen. Calibrate the three water streams (mix, still and sparkling) by following the Water Calibration Procedure found at the end of this Section 2, Page 25.
22. After completing the water calibration return to the HOME screen by pressing the Return Arrow in the upper left of the touchscreen to back out of all service screens.
23. Check for CO₂ leaks, check for water leaks.
24. The dispenser should now be ready to use after the dispenser reaches temperature. The first cooling cycle will take approximately 70 minutes.
25. Enable and set the MAX TEMP if so desired to ensure that every beverage is served chilled. It is recommended that this feature is Disabled unless a user has asked for colder beverages.
26. Should the 5 gallon bottle run out of water then the Lavit pump kit will sound an alarm and the reset button will turn from green to red. Change the bottle and press the reset button. Failure to change the bottle could result in a dry vend on a capsule beverage.